



*Jordan fishwick*

88 Longford Road, Chorlton, M21 9NP

Guide Price £425,000



### The Property

A delightful THREE BEDROOM MID TERRACE PERIOD PROPERTY located on a sought after road within only a short stroll of both Chorlton Village and Longford Park. This splendid property will prove ideal for a young couple or family and boasts a 17ft open plan living/dining/kitchen as well as many ORIGINAL FEATURES throughout. The accommodation briefly comprises: entrance hallway, lounge with large bay window, open plan living/dining/kitchen with integrated appliances and large glazed patio door opening to the walled rear garden. To the first floor there are three good sized bedrooms and bathroom, fitted with a modern three piece suite. Both double glazing and gas central heating have been installed throughout. Externally, to the front of the property is a walled garden with gated path leading to the front door while to the rear, a courtyard garden features a flagged patio and large well stocked beds. An internal viewing is strongly recommended. Council Tax: A.

**88 Longford Road, Chorlton,  
Manchester, M21 9NP**

**Guide Price £425,000**



- Delightful well presented mid terrace period property
- Three good sized bedrooms and two reception rooms
- Open plan living/dining/kitchen
- Well maintained gardens to both the front and rear
- Sought after road walking distance from Chorlton Village and Longford Park
- Ideally placed for multiple local schools
- Short stroll to Beech Road
- Many original features retained
- Ideal for young couple or family



Energy Efficiency Rating		
	Current	Potential
Very energy efficient - lower running costs		
(92 plus) <b>A</b>		
(81-91) <b>B</b>		<b>85</b>
(69-80) <b>C</b>		
(55-68) <b>D</b>	<b>67</b>	
(39-54) <b>E</b>		
(21-38) <b>F</b>		
(1-20) <b>G</b>		
Not energy efficient - higher running costs		
<b>England &amp; Wales</b>	EU Directive 2002/91/EC	



GROUND FLOOR  
450 sq.ft. (41.8 sq.m.) approx.

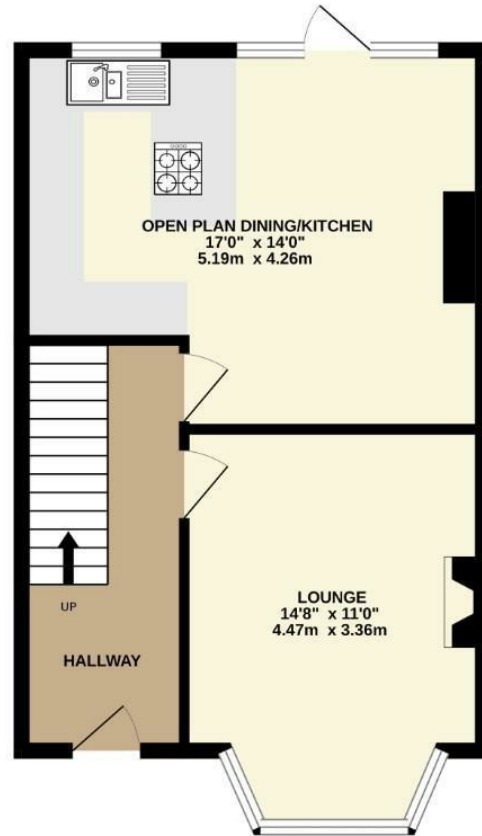

1ST FLOOR  
420 sq.ft. (39.0 sq.m.) approx.

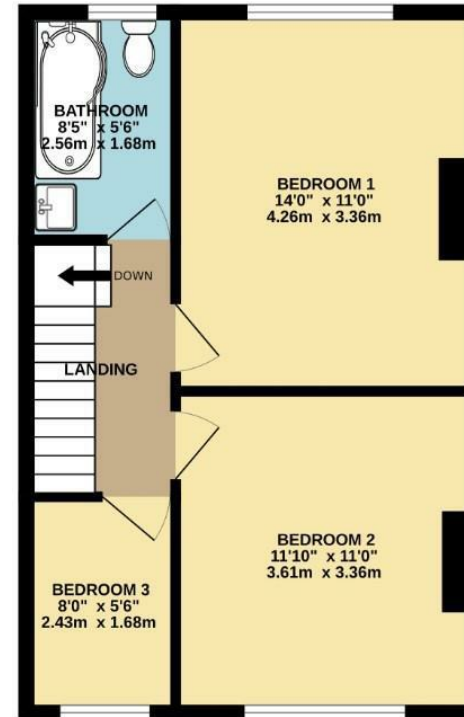

TOTAL FLOOR AREA: 870 sq.ft. (80.8 sq.m.) approx.  
Measurements are approximate. Not to scale. Illustrative purposes only  
Made with Metropix ©2025



These particulars are believed to be accurate but they are not guaranteed and do not form a contract. Neither Jordan Fishwick nor the vendor or lessor accept any responsibility in respect of these particulars, which are not intended to be statements or representations of fact and any intending purchaser or lessee must satisfy himself by inspection or otherwise as to the correctness of each of the statements contained in these particulars. Any floorplans on this brochure are for illustrative purposes only and are not necessarily to scale.

Offices at: Chorlton, Didsbury, Disley, Hale, Glossop, Macclesfield, Manchester Deansgate, Manchester Whitworth Street, New Mills, Sale, Wilmslow and Withington